

A17051 Series Ø170X51mm(Ø6.7"X2")

[View WebPage](#)
[View 3D Object](#)



HOUSING	Die-Cast Aluminum, Painted Black
IMPELLER	Thermoplastic PBT, UL94V-0
BEARING	Ball
TERMINATION	Terminals, Lead wire.
OPERATING VOLTAGE RANGE	50 VAC for 120 VAC Type 100 VAC for 230 VAC Type
DIELECTRIC STRENGTH	1,500 VAC for 1 minute
INSULATION	Class B
INSULATION RESISTANCE	100,000 Ohms min. @ 500VDC
OPERATING TEMPERATURE	-20 °C TO + 80 °C
SAFETY	Thermally Protected (Auto Restart)
WEIGHT	875g
ROHS COMPLIANCE	Yes

SPECIFICATION

MODEL NO.	RATED VOLTAGE (V)	FREQUENCY (Hz)	RATED CURRENT (A)	INPUT POWER (W)	SPEED RPM	MAX. AIR PRESSURE		AIR FLOW		NOISE dB(A) @1M
						InchH ₂ O	mmH ₂ O	m ³ /min	CFM	
A17051V1H	115	50/60	0.22/0.28	25/31	2800/3350	0.61/0.66	15.5/16.8	5.57/6.42	195/225	57/61
A17051V2H	230	50/60	0.11/0.14	24/30	2800/3350	0.61/0.66	15.5/16.8	5.57/6.42	195/225	57/61
A17051V1L	115	50/60	0.15/0.15	17/16	1400/1800	0.18/0.25	4.57/6.35	2.83/3.41	100/121	39/44
A17051V2L	230	50/60	0.06/0.06	14/13	1400/1800	0.18/0.25	4.57/6.35	2.85/3.41	101/120	39/44

DIMENSION

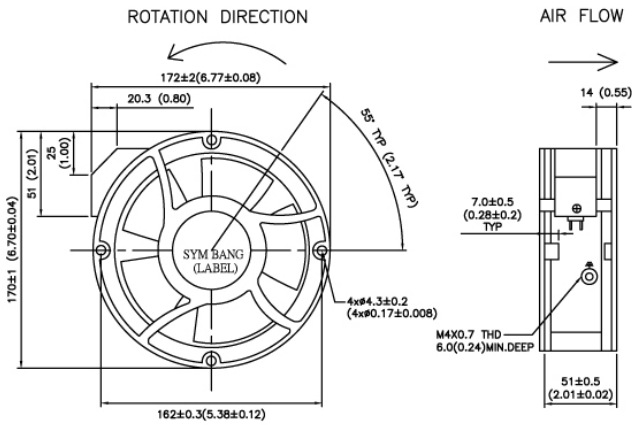

AIR PERFORMANCE

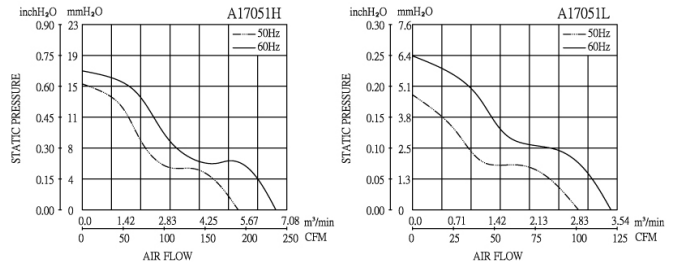

Mountion Panel Cutout Outlet Side & Inlet Side

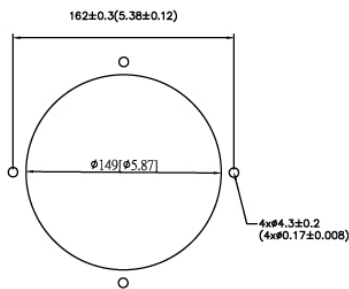

UNIT:mm(inch)