

## A9238M Series 92X92X38mm(3.62"X3.62"X1.50")

[View WebPage](#)  
[View 3D Object](#)



<b>HOUSING</b>	All Metal Die-Cast Aluminum, Painted Black
<b>IMPELLER</b>	Metal
<b>BEARING</b>	Ball or Sleeve
<b>TERMINATION</b>	Lead Wire
<b>DIELECTRIC STRENGTH</b>	1,500 VAC for 1 minute
<b>INSULATION</b>	Class B
<b>INSULATION RESISTANCE</b>	100,000 Ohms min. @ 500 VDC
<b>OPERATING TEMPERATURE</b>	-30oC to + 75oC for Ball Type -10oC to + 80oC for Sleeve Type
<b>SAFETY</b>	Impedance Protected
<b>WEIGHT</b>	420g
<b>ROHS COMPLIANCE</b>	Yes

### SPECIFICATION

MODEL NO.	RATED VOLTAGE (V)	FREQUENCY (Hz)	RATED CURRENT (A)	INPUT POWER (W)	SPEED RPM	MAX. AIR PRESSURE		AIR FLOW		NOISE dB(A) @1M
						InchH <sub>2</sub> O	mmH <sub>2</sub> O	m <sup>3</sup> /min	CFM	
A9238V1HM	115	50/60	0.15/0.12	10/9	2700/3000	0.17/0.20	4.32/5.08	1.10/1.30	40/45	35/37
A9238V1MM	115	50/60	0.12/0.10	8.5/7.0	2300/2500	0.14/0.15	3.56/3.81	0.93/1.10	33/40	24/25
A9238V1LM	115	50/60	0.09/0.07	7.0/6.0	2000/2200	0.10/0.11	2.54/2.79	0.76/0.85	27/30	22/24
A9238V2HM	230	50/60	0.15/0.12	16/13	2700/3000	0.17/0.20	4.32/5.08	1.10/1.30	40/45	35/37
A9238V2MM	230	50/60	0.10/0.08	14/11	2300/2500	0.14/0.15	3.56/3.81	0.93/1.10	33/40	24/25
A9238V2LM	230	50/60	0.09/0.07	11/9.0	2000/2200	0.10/0.11	2.54/2.79	0.76/0.85	27/30	22/24

### DIMENSION

### AIR PERFORMANCE

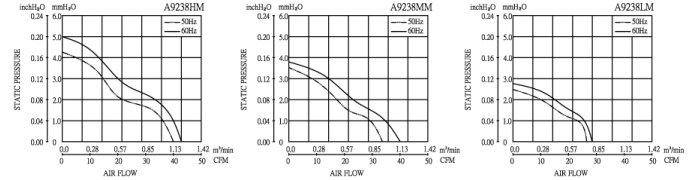
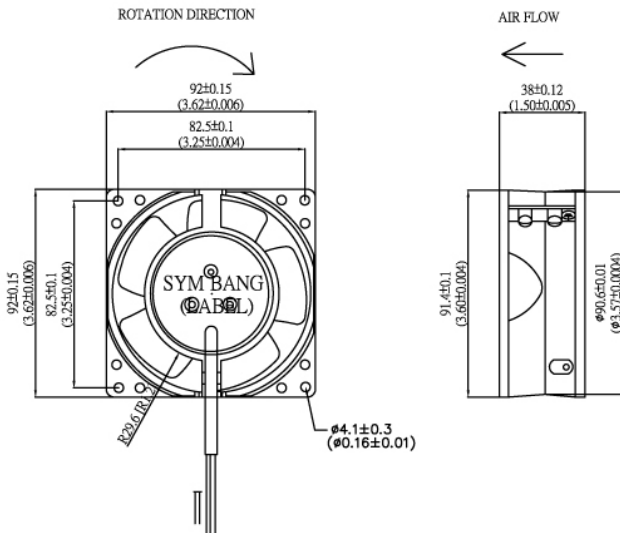

Mountiom Panel Cutout  
 Outlet Side & Inlet Side

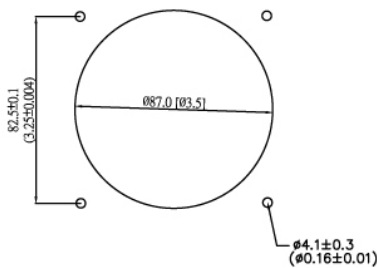

UNIT:mm(inch)