

AB18970 Series 189X183X70mm(7.44"X7.20"X2.75")

[View WebPage](#)
[View 3D Object](#)



HOUSING	Aluminum die-cast, Natural, Milled or Black painted
IMPELLER	Glass reinforced PBT thermoplastic rates, UL 94V-0
BEARING	Ball
TERMINATION	Lead Wire
OPERATING VOLTAGE RANGE	50VAC for 115 V Type 100VAC for 230 V Type
DIELECTRIC STRENGTH	1,500VAC for 1minute
INSULATION	Class B
INSULATION RESISTANCE	100,000 Ohms min. @ 500 VDC
OPERATING TEMPERATURE	-30 °C ~+85 °C
SAFETY	Impedance Protected
WEIGHT	1.65kgs
ROHS COMPLIANCE	Yes

SPECIFICATION

MODEL NO.	RATED VOLTAGE (V)	FREQUENCY (Hz)	RATED CURRENT (A)	INPUT POWER (W)	SPEED RPM	MAX. AIR PRESSURE		AIR FLOW		NOISE dB(A) @1M
						InchH ₂ O	mmH ₂ O	m ³ /min	CFM	
AB18970V1H	115	50/60	0.81/0.99	65/80	2800/3100	1.6/1.8	41/46	2.6/2.9	90/100	64/68
AB18970V1M	115	50/60	0.68/0.87	55/70	2200/2300	1.4/1.5	36/38	2.3/2.1	75/80	55/56
AB18970V1L	115	50/60	0.56/0.75	45/60	1400/1600	0.9/1.0	23/25	1.6/1.9	55/65	46/48
AB18970V2H	230	50/60	0.40/0.50	65/80	2800/3100	1.6/1.8	41/46	2.6/2.9	90/100	64/68
AB18970V2M	230	50/60	0.34/0.43	55/70	2200/2400	1.4/1.5	36/38	2.3/2.1	75/80	55/56
AB18970V2L	230	50/60	0.28/0.37	45/60	1400/1600	0.9/1.0	23/25	1.6/1.9	55/65	46/48

DIMENSION

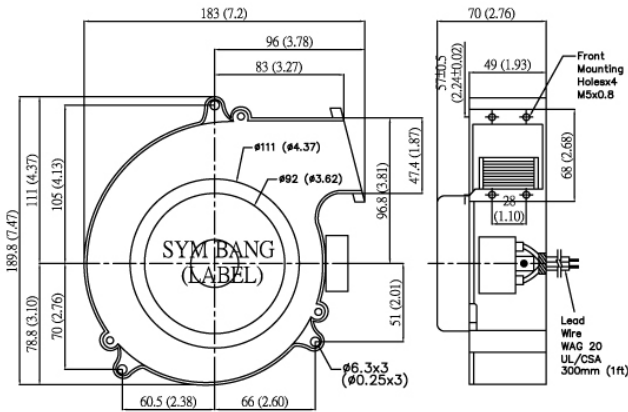

AIR PERFORMANCE

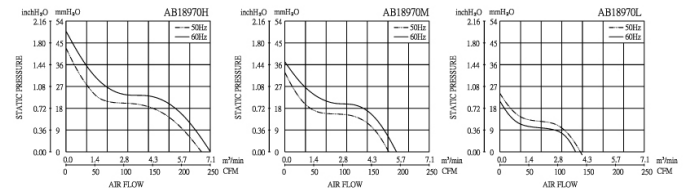

Mountion Panel Cutout Outlet Side & Inlet Side

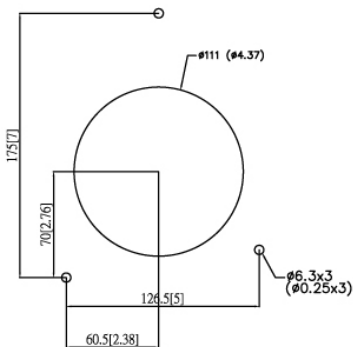

UNIT: mm(inch)