

DB12137 Series 121X121X37mm(4.76"X4.76"X1.46")

[View WebPage](#)
[View 3D Object](#)



HOUSING	Plastic with Fiber Glass Filled UL 94V-0
IMPELLER	Plastic with Fiber Glass Filled UL 94V-0
BEARING	Ball Bearing or Sleeve Bearing
OPERATING TEMPERATURE	Sleeve Bearing:-10 °C to +70 °C Ball Bearing:-20 °C to +80 °C
INSULATION RESISTANCE	10 meg Ohms Min.@500 VDC
DIELECTRIC STRENGTH	5 mA Max. at 500 VAC 60Hz for 1 minute
WEIGHT	500g
ROHS COMPLIANCE	YES

SPECIFICATION

MODEL NO.	RATED VOLTAGE (V)	RATED CURRENT (A)	INPUT POWER (W)	SPEED (RPM)	MAX. AIR PRESSURE		Maximum Air Flow		NOISE dB(A) @1M
					inchH ₂ O	mmH ₂ O	CFM	m ³ /min	
DB12137V12H	12	0.95	11.5	2800	0.75	19.05	26	0.73	55
DB12137V12M	12	0.63	7.5	2500	0.52	13.21	22	0.62	52
DB12137V24H	24	0.42	10	2800	0.75	19.05	26	0.73	55
DB12137V24M	24	0.31	7.5	2500	0.52	13.21	22	0.62	52
DB12137V48H	48	0.23	11	2800	0.75	19.05	26	0.73	55
DB12137V48M	48	0.16	7.7	2500	0.52	13.21	22	0.62	52

DIMENSION

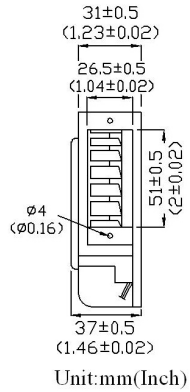
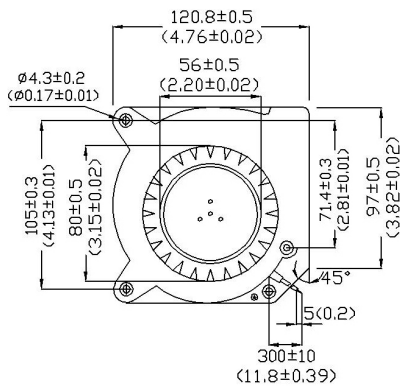

AIR PERFORMANCE

