

PLUG TYPE 3.4 × 1.4

No.MP-121WK
3.4 × 1.4 DC PLUG
(DC12V 0.5A)

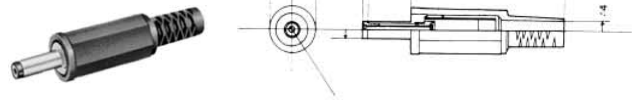

No.MP-121WH
3.4 × 1.4 DC PLUG
(DC12V 0.5A)



No.MP-121WN
3.4 × 1.4 RIGHT ANGLE DC PLUG
(DC12V 0.5A)

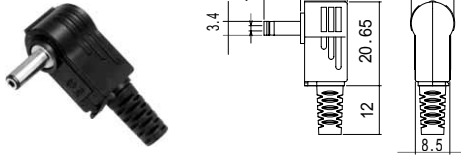

No.MJ-82-1
DC JACK FOR P.C.B.
PLUG TYPE: 3.4 × 1.4
(DC6V 0.5A)

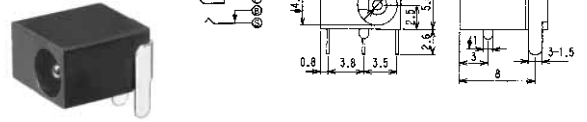

No.MJ-83
DC JACK FOR P.C.B.
PLUG TYPE: 3.4 × 1.4
(DC6V 0.5A)

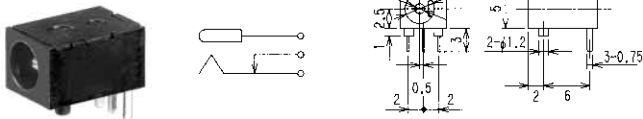

No.MJ-84
DC JACK FOR P.C.B.
PLUG TYPE: 3.4 × 1.4
(DC6V 0.5A)

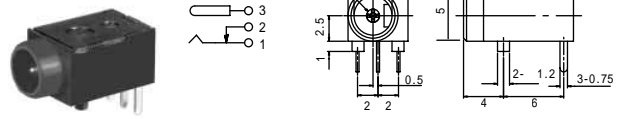

No.MJ-25N1
DC JACK FOR P.C.B.
PLUG TYPE: 3.4 × 1.4
(DC6V 0.5A)

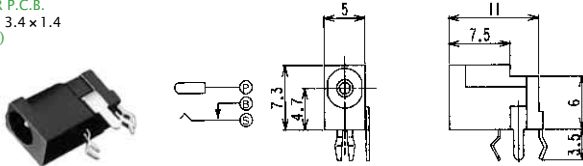

No.MJ-44
PANEL MOUNT DC JACK
PLUG TYPE: 3.4 × 1.4
(DC12V 0.5A)

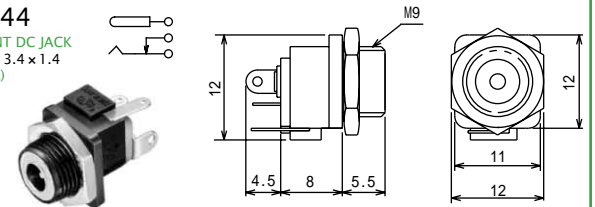

No.MJ-441DJ
DC JACK FOR P.C.B.
PLUG TYPE: 3.4 × 1.4
(DC6V 0.5A)

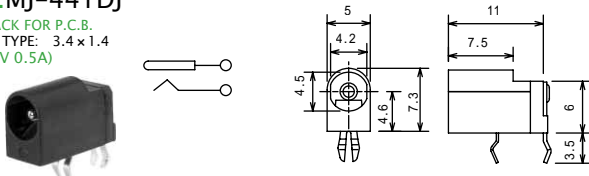

No.MJ-74
PANEL MOUNT DC JACK
PLUG TYPE: 3.4 × 1.4
(DC12V 0.5A)

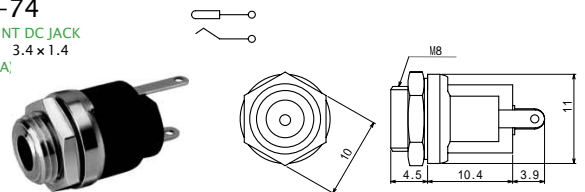

No.MJ-99
PANEL MOUNT DC JACK
PLUG TYPE: 3.4 × 1.4
(DC12V 0.5A)

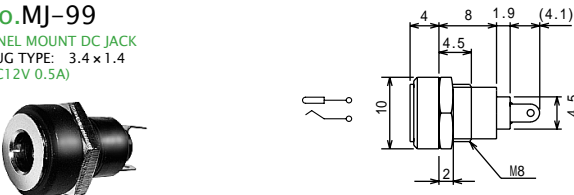

No.MJ-099N
DC INLINE JACK
PLUG TYPE: 3.4 × 1.4
(DC12V 0.5A)

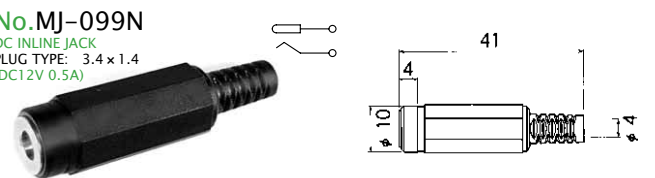

PLUG TYPE 3.8 × 1.4

No.MP-138NK
3.8 × 1.4 DC PLUG
(DC12V 0.5A)

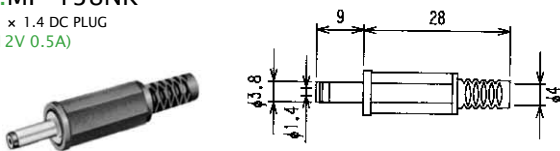

No.MJ-45
PANEL MOUNT DC JACK
PLUG TYPE: 3.8 × 1.4
(DC12V 0.5A)

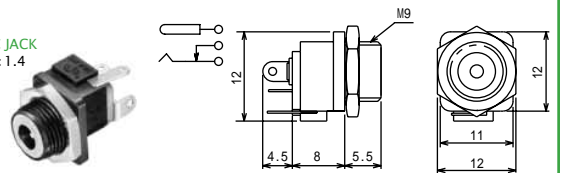

No.MJ-99/3.8
PANEL MOUNT DC JACK
PLUG TYPE: 3.8 × 1.4
(DC12V 0.5A)

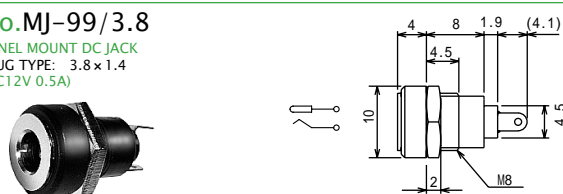

No.MJ-75
PANEL MOUNT DC JACK
PLUG TYPE: 3.8 × 1.4
(DC12V 0.5A)

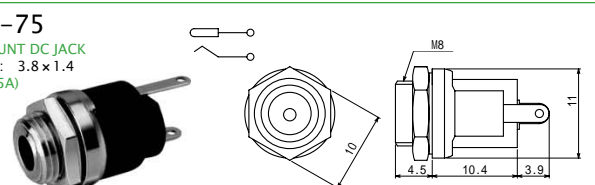

No.MJ-099N/3.8
DC INLINE JACK
PLUG TYPE: 3.8 × 1.4
(DC12V 0.5A)

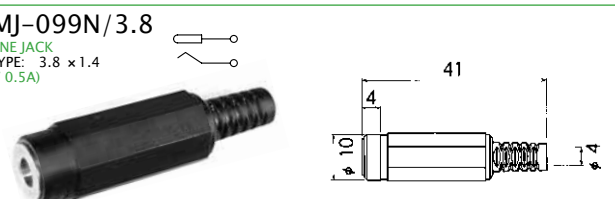

PLUG TYPE 3.0 × 1.0

No.MP-121PS
3.0 × 1.1 DC PLUG
(DC12V 0.5A)

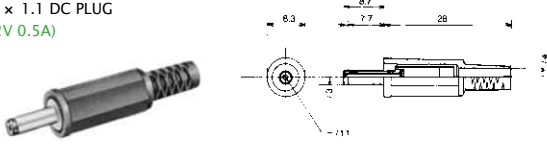

No.MP-121PN
3.0 × 1.1 RIGHT ANGLE DC PLUG
(DC12V 0.5A)

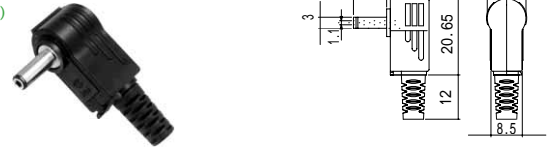

No.MJ-25N
DC JACK FOR P.C.B.
PLUG TYPE: 3.0 × 1.1
(DC6V 0.5A)

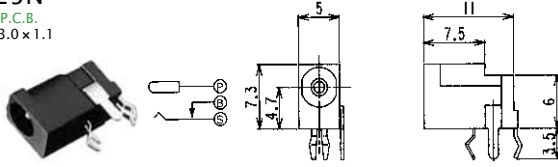

No.MJ-82-2
DC JACK FOR P.C.B.
PLUG TYPE: 3.0 × 1.1
(DC6V 0.5A)

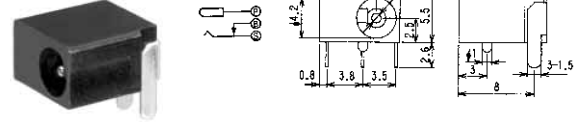

No.MJ-442DJ
DC JACK FOR P.C.B.
PLUG TYPE: 3.0 × 1.1
(DC6V 0.5A)

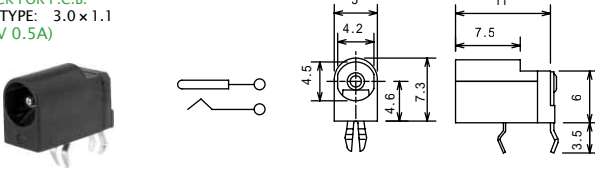

PLUG TYPE 3.5 × 1.1

No.MP-135NK
3.5 × 1.1 DC PLUG
(DC12V 0.5A)

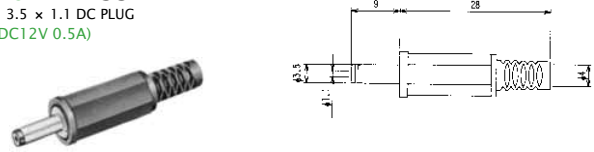

PLUG TYPE 7.5 × 4.1 (CENTER PIN 1)

No.MP-139SF
7.5 × 4.1 (CENTER PIN: 1) DC PLUG
(DC12V 2A)

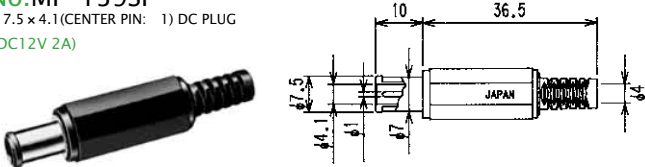

PLUG TYPE 6.3 × 3.1

No.MP-065L
6.3 × 3.1 DC PLUG
(DC12V 2A)



No.MJ-065M
PANEL MOUNT DC JACK
PLUG TYPE: 6.3 × 3.1
(DC12V 2A)

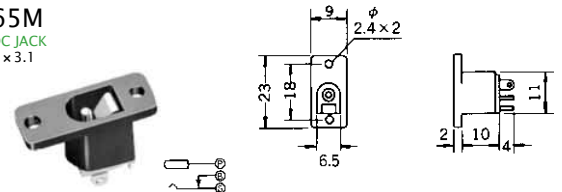

LOCKABLE DC PLUGS & JACKS

ロック式DCプラグ&ジャック

LOCKABLE DC JACK FOR PANEL MOUNT

No.MJ-10LR
TO MATE WITH MP-121AR
MP-121MR & MC1210LR
(DC12V 0.5A)

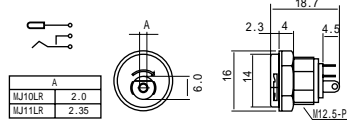

No.MJ-11LR
TO MATE WITH MP-122AR
MP-122MR & MC1220LR
(DC12V 1A)

	A
MJ10LR	2.0
MJ11LR	2.35

LOCKABLE DC SOCKET FOR P.C.B.

No.MJ-179LR
TO MATE WITH MP-121AR
MP-121MR & MC1210LR
(DC12V 0.5A)

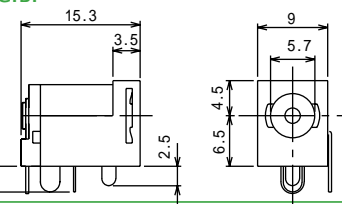

No.MJ-180LR
TO MATE WITH MP-122AR
MP-122MR & MC1220LR
(DC12V 1A)

DC-PLUG WITH LOCKING DETENT

No.MP-121LL
TO MATE WITH MJ-179R & MJ-10LR
(DC12V 0.5A)

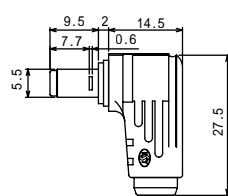

No.MP-122LL
TO MATE WITH MJ-180LR & MJ-11LR
(DC12V 1A)

DC-PLUG WITH LOCKING DETENT

No.MP-121AR
TO MATE WITH MJ-179R & MJ-10LR
(DC12V 0.5A)

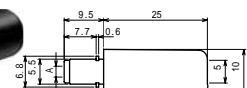

No.MP-122AR
TO MATE WITH MJ-180LR & MJ-11LR
(DC12V 1A)

DC ADAPTER CABLE FOR LOCKABLE DC JACK

ロック式DCジャック専用DCプラグ付ケーブル L=1800

No.MC-1210LR

TO MATE WITH MJ-179LR & MJ-10LR
(DC12V 0.5A)

No.MC-1220LR

TO MATE WITH MJ-180LR & MJ-11LR
(DC12V 1A)



DC-PLUG WITH LOCKING DETENT FOR MOLDING

No.MP-121MR
TO MATE WITH MJ-179R & MJ-10LR
(DC12V 0.5A)

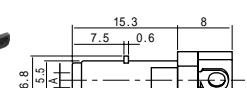

No.MP-122MR
TO MATE WITH MJ-180LR & MJ-11LR
(DC12V 1A)



DC PLUGS & JACKS

EIAJ RC5321

JACK FOR LOW VOLTAGE DC POWER SUPPLY OUTPUT AND MATING PLUG
DC電源出力用プラグ・ジャック 電圧区分4 適合品
TYPE4

RATING 定 格 : DC13.5V 2A

No.MP-214

EIAJ RC-5321 CLASS4 電圧区分4
(DC13.5V 2A)

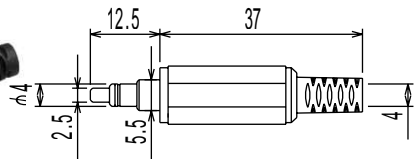

No.M04-510DJ

DC JACK FOR P.C.B.
EIAJ RC-5321 CLASS4 電圧区分4
(DC13.5V 2A)

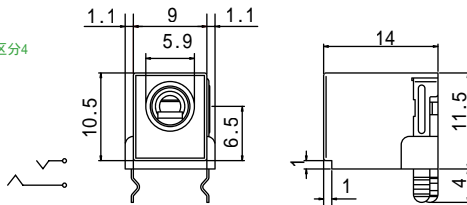

EIAJ RC5322

TO ELECTRONIC EQUIPMENT USED IN A CAR

車載機器用

RATING 定 格 : DC24V 2A

No.MP-206

6.5 × 3.1 (center pin : 1.0) DC PLUG
(DC24V 2A)

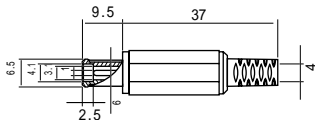

No.MJ-300J

DC JACK FOR P.C.B.
PLUG TYPE: 6.5 × 3.1 (center pin : 1.0)
(DC24V 2A)

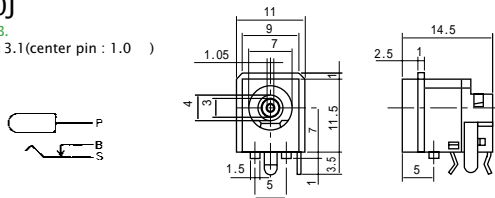

Marushin electric mfg. co., Ltd.